

ALGONKIAN PARK POOL RENOVATIONS

NORTHERN VIRGINIA REGIONAL
 PARK AUTHORITY
 FAIRFAX STATION, VA

DATE: OCTOBER 11, 2000

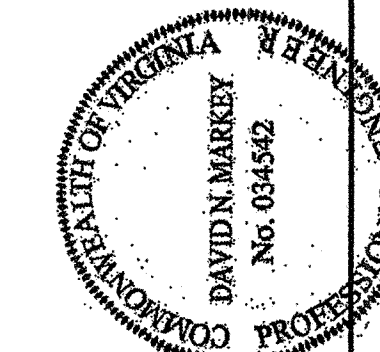

ENGINEER'S PROJECT NO. 0002

As BUILT

INDEX TO DRAWINGS

SHT. NO.	DESCRIPTION	SHT. NO.	DESCRIPTION	SHT. NO.	DESCRIPTION	SHT. NO.	DESCRIPTION	SHT. NO.	DESCRIPTION
0	COVER SHEET AND INDEX								
D1	DEMOLITION PLAN								
PA1	POOL AREA PLAN								
PA2	PLAY POOL PLAN								
PA3	PLAY POOL SECTION & DETAILS								
PA4	POOL DETAILS								
PM1	POOL MECHANICAL GENERAL LAYOUT								
PM2	PLAY POOL MECHANICAL PLAN								
PM3	FILTER ROOM PLAN								
PM4	FILTER & CHEMICAL FEED SCHEMATICS								
PM5	POOL MECHANICAL DETAILS								
PE1	POOL ELECTRICAL PLAN								

A-87

No.	Revision	Date
	Revision Block	

GRADING PLAN FOR

ALGONKIAN REGIONAL PARK POOL RENOVATION

BROAD RUN DISTRICT
LOUDOUN COUNTY, VIRGINIA

OWNER/DEVELOPER

NORTHERN VIRGINIA REGIONAL PARK AUTHORITY

5400 OX ROAD
FAIRFAX STATION, VA. 22039
TELEPHONE: (703) 352-5900



William H. Gordon Associates, Inc.
Engineers • Land Planners • Landscape Architects • Surveyors

4501 DALY DRIVE CHANTILLY, VIRGINIA 22021

(703) 263-1900

PROJECT MANAGER: ROBERT W. WALKER, C.L.A.

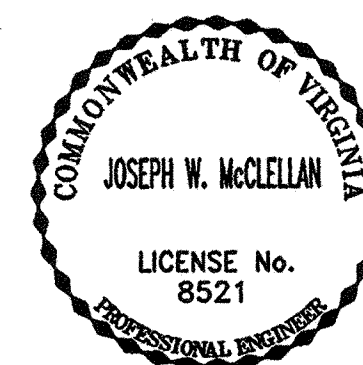
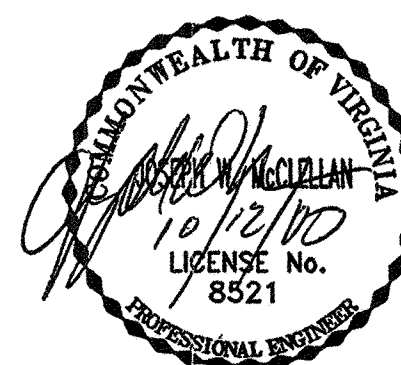

DIRECTOR'S APPROVAL

DIRECTOR	DATE	ORDINANCE SECTION
DEPARTMENT OF BUILDING & DEVELOPMENT		

LIST OF DRAWINGS

- COVER SHEET
- GENERAL NOTES AND CONSTRUCTION DETAILS
- DEMOLITION PLAN
- GRADING PLAN
- EROSION SEDIMENT STAGE I & II PLAN
- WATER QUALITY (BMP) FACILITY AND NARRATIVE

EXISTING	LEGEND	PROPOSED
---	PROPERTY LINE	---
---	DEPARTING PROPERTY LINE	---
---	EASEMENT LINE	---
---	EDGE PAVEMENT	---
---	CENTERLINE	---
-x-x-	FENCE LINE	-x-x-
+	RAILROAD	+
G	GAS LINE	G
○-○	OVERHEAD ELECTRIC	○-○
○-○	UNDERGROUND ELECTRIC LINE	○-○
○-○	OVERHEAD TELEPHONE LINE	○-○
○-○	UNDERGROUND TELEPHONE LINE	○-○
.....	ROADSIDE DELINEATORS
.....	GUARDRAIL OR TRAFFIC BARRICADE
○	WATER MAIN	○
TO BE REMOVED	BUILDINGS	PROP. BLDG.
TO REMAIN	RETAINING WALL	---
---	SIDEWALK	---
---	HEADER CURB	---
---	CURB & GUTTER	---
CG-6 TRANS CG-6R	SANITARY SEWER	CG-6 TRANS CG-6R
○	STORM SEWER	○
---	DITCH, SWALE OR SMALL STREAM	---
---	LARGE STREAM	---
---	CONCRETE DITCH	---
○	TREES	○
---	TREE LINE	---
---	LIMITS OF CLEARING & GRADING	---
---	CONTOUR LINE	---
---	SPOT ELEVATION	---

VICINITY MAP
SCALE: 1"=1000'

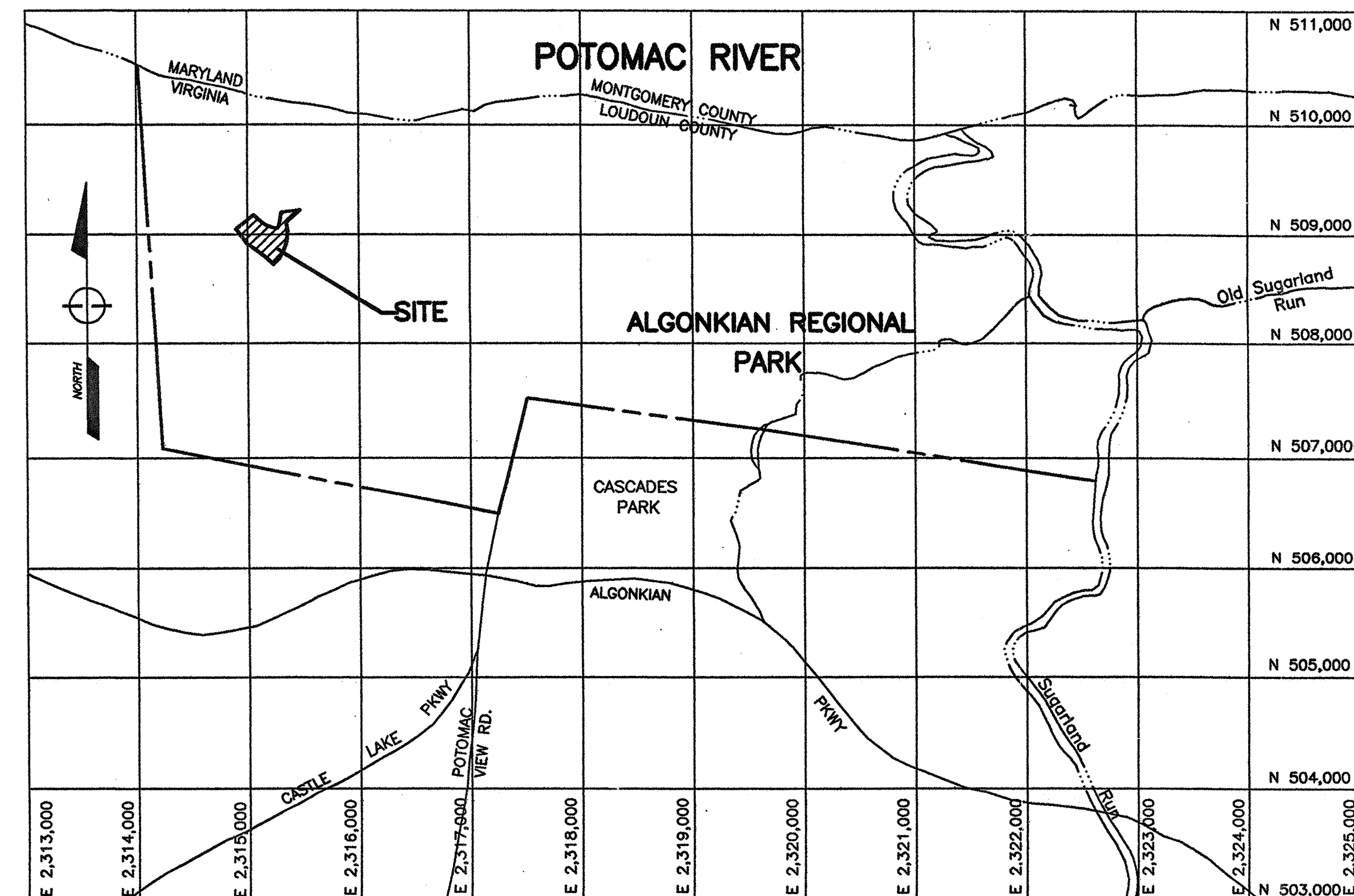

GENERAL NOTES

- THIS PARCEL IS IDENTIFIED AS LOUDOUN COUNTY TAX MAP NO. 64, PARCELS 5 AND 5A.
- THE TOTAL AREA OF DISTURBANCE IS APPROXIMATELY 1.0 ACRES.
- TOPOGRAPHIC SURVEY FOR THE GRADING PLANS IS FROM A FIELD RUN SURVEY BY WILLIAM H. GORDON ASSOCIATES, INC.
- THE TOPOGRAPHIC CONTOUR INTERVAL IS TWO (2) FEET (UNLESS OTHERWISE NOTED).
- THE CONTRACTOR SHALL BE RESPONSIBLE FOR NOTIFYING THE OWNER AND THE ENGINEER OF ANY CHANGES OR CONDITIONS ATTACHED TO THE GRADING PERMIT.
- WILLIAM H. GORDON ASSOCIATES, INC. DOES NOT CERTIFY TO THE LOCATION OF OR THE EXISTENCE OF ANY UNDERGROUND UTILITIES. THE UNDERGROUND UTILITIES SHOWN ARE FROM AVAILABLE RECORDS. THIS DOES NOT CONSTITUTE GUARANTEE OF THEIR ACTUAL LOCATION OR THAT THEY HAVE ALL BEEN SHOWN. THE CONTRACTOR SHALL BE RESPONSIBLE FOR THE DIGGING OF TEST HOLES PRIOR TO BEGINNING ANY CONSTRUCTION. THESE TEST HOLES WILL BE MADE TO VERIFY ALL EXISTING CONDITIONS. IF CONDITIONS ARE FOUND IN THE FIELD WHICH ARE MATERIALLY DIFFERENT FROM THE PLANS, THE CONTRACTOR SHALL NOTIFY WILLIAM H. GORDON ASSOCIATES, INC. SO THE APPROPRIATE REVISIONS CAN BE MADE TO THE PLANS.
- SEE COVER SHEET FOR LEGEND OF SYMBOLS USED HEREIN.
- CONTRACTOR SHALL NOTIFY OPERATORS WHO MAINTAIN EXISTING UNDERGROUND UTILITY LINES IN THE AREA OF PROPOSED EXCAVATION OR BLASTING AT LEAST TWO (2) WORKING DAYS, BUT NOT MORE THAN TEN (10) WORKING DAYS, PRIOR TO COMMENCEMENT OF EXCAVATION OR DEMOLITION. CONTRACTOR SHALL CONTACT "MISS UTILITY" AT 1-800-275-7777 PRIOR TO COMMENCEMENT OF ANY EXCAVATION.

MISS UTILITY CONTACT NUMBERS (PARTIAL LIST)

UTILITY	UTILITY COMPANY	TELEPHONE NUMBER
WATER	LOUDOUN COUNTY SANITATION AUTHORITY	(703) 771-1095
SANITARY SEWER	LOUDOUN COUNTY SANITATION AUTHORITY	(703) 771-1095
STORM SEWERS	LOUDOUN COUNTY DEPARTMENT OF BUILDING & DEVELOPMENT	(703) 777-0397
GAS	COLUMBIA GAS TRANSMISSION CORP. WASHINGTON GAS CNG TRANSMISSION CORP.	(703) 759-2115 (703) 750-9500 (703) 527-1531
ELECTRIC	VIRGINIA POWER NOVEC	(703) 547-1291 (703) 777-2041
TELEPHONE AT&T	BELL ATLANTIC	(703) 430-5310 611
CABLE	PRIME CABLE	(703) 478-1825
OTHER	MISS UTILITY	(800) 257-7777

- ALL LAND ON OR OFF-SITE WHICH IS DISTURBED BY CONSTRUCTION AND WHICH IS NOT BUILT UPON OR SURFACED SHALL BE ADEQUATELY STABILIZED TO CONTROL EROSION AND SEDIMENTATION.
- THE CONTRACTOR SHALL PROVIDE ADEQUATE MEANS OF CLEANING TRUCKS AND/OR EQUIPMENT OF MUD PRIOR TO ENTERING THE WOOD RIGHT-OF-WAY. IT IS THE CONTRACTOR'S RESPONSIBILITY TO CLEAN STREETS OF MUD AND/OR ALLAY DUST OR TAKE WHATEVER MEASURES NECESSARY TO ENSURE THAT THE STREETS ARE KEPT IN A CLEAN AND DUST-FREE CONDITION AT ALL TIMES.
- THE CONTRACTOR SHALL VISIT THE SITE AND SHALL VERIFY EXISTING CONDITIONS PRIOR TO STARTING CONSTRUCTION.
- UNLESS OTHERWISE NOTED, ALL PROPOSED ELEVATIONS AS SHOWN HEREON ARE FINISHED GRADE.
- CONTROLLED FILL:
 - CONTROLLED COMPACTION SHALL OCCUR IN ALL FILL SECTIONS FOR PAVEMENT, TRENCHES FOR UTILITIES, AND IN ANY AREA DESIGNATED ON THE DRAWINGS.
 - CONTROLLED FILLS MUST BE COMPACTED TO 95% DENSITY AS DETERMINED BY METHODS AS PER STANDARD PROCTOR AASHTO-T99 OR ASTM-B698. DENSITY MUST BE VERIFIED BY A QUALIFIED SOILS ENGINEER.
 - CONTROLLED FILLS SHALL BE COMPACTED IN EIGHT (8) INCH LIFTS (LOOSE THICKNESS) TO THE SPECIFIED DENSITY, BEGINNING FROM THE EXISTING GROUND SURFACE, UNLESS OTHERWISE APPROVED IN WRITING BY A QUALIFIED SOILS ENGINEER.
 - THE SURFACE AREA DIRECTLY BENEATH AREAS TO RECEIVE CONTROLLED FILLS OF LESS THAN FIVE (5) FEET IS TO BE DENUDED OF ALL VEGETATION AND SCARIFIED AND COMPACTED TO A DEPTH OF SIX (6) INCHES TO THE SAME DENSITY AS THE CONTROLLED FILL TO BE PLACED THEREIN.
- ALL TEST, STUDIES, ETC., WILL BE CARRIED OUT AT THE EXPENSE OF THE OWNER.

STORMWATER NARRATIVE

THIS SITE LIES WITHIN THE 100 YEAR FLOODPLAIN FOR THE POTOMAC RIVER, THEREFORE, STORMWATER MANAGEMENT(SWM) IS NOT REQUIRED.

PROJECT AND EROSION AND SEDIMENT CONTROL NARRATIVE

PROJECT DESCRIPTION:

THIS PROJECT PROPOSES TO RENOVATE AN EXISTING POOL. THIS WILL INCLUDE CONCRETE DECK ADDITION AREAS, THE INSTALLATION OF NEW FAMILY PLAY POOL AND DUAL SLIDES WITH TOWER. APPROXIMATELY 1.0 AC OF LAND WILL BE DISTURBED WITH THIS PROJECT.

EXISTING CONDITIONS:

ALL OF THIS PROJECT SITE IS WITHIN THE 100 YEAR FLOODPLAIN OF THE POTOMAC RIVER. THE EXISTING RAISED ASPHALT SERVICE ROAD IS AN EXISTING DRAINAGE DIVIDE WITH SWALES ON EITHER SIDE AT SOME POINTS.

GENERAL EROSION CONTROL NOTES:

DEVICES SHOWN BELOW ARE TO BE CONSIDERED MINIMUM EROSION AND SILTATION CONTROLS. ADDITIONAL CONTROLS MAY BE NECESSARY DUE TO CONTRACTOR PHASING OR OTHER UNANTICIPATED CONDITIONS. IT IS THE CONTRACTOR'S RESPONSIBILITY TO PROVIDE ADDITIONAL DEVICES TO THOSE SHOWN IN ORDER TO CONTROL EROSION AND SILTATION.

EROSION AND SILTATION CONTROL MEASURES SHALL BE INSTALLED AND MAINTAINED ACCORDING TO THE STANDARDS AND SPECIFICATIONS IN THE VIRGINIA EROSION AND SEDIMENT CONTROL HANDBOOK.

TREES TO BE SAVED ARE TO BE TO BE PROTECTED FROM EQUIPMENT DAMAGE. PROTECTION TO BE LOCATED AT THE DRIP LINE OF TREES (LIMITS OF DISTURBANCE).

APPLY PERMANENT VEGETATION (SODDING AND SEEDING) WITH SOIL PREPARATION. AMENDMENTS AND SEED MIXTURE AS DETERMINED BY N.V.R.P.A.

EROSION/SEDIMENT CONTROL PROGRAM:

DUE TO THE SIMPLE NATURE OF THIS CONSTRUCTION BOTH THE STAGE I AND STAGE II EROSION SEDIMENT CONTROLS ARE INCLUDED ON THE SAME DRAWING.

EROSION CONTROL REQUIREMENTS

- NO DISTURBED AREA SHALL BE LEFT DENUDED FOR MORE THAN SEVEN (7) CALENDAR DAYS UNLESS AUTHORIZED BY THE DIRECTOR OR HIS AGENT (SPECIFIC AREAS TO BE DETERMINED IN THE FIELD PRIOR TO COMMENCING CONSTRUCTION).
- NO MORE THAN 50% OF THE SITE SHALL BE DENUDED AT ONE TIME.
- TOPSOIL THAT HAS BEEN STOCKPILED IS TO BE SURROUNDED BY SILT FENCE AND SHALL BE PROTECTED BY MULCH AND/OR TEMPORARY VEGETATION IMMEDIATELY AFTER GRADING.
- ALL CUT AND FILL SLOPES ARE TO BE SEEDED AND MULCHED WITHIN FIVE (5) DAYS OF COMPLETION OF GRADING.
- ANY DISTURBED AREA NOT PAVED, SODDED OR BUILT UPON BY NOVEMBER 1, OR DISTURBED AFTER NOVEMBER 1, IS TO BE SEEDED WITHIN FIFTEEN (15) DAYS WITH OATS, ABRUZZI RYE OR EQUIVALENT, AND MULCHED WITH STRAW OR HAY MULCH AT THE RATE OF TWO (2) TONS PER ACRE.

SEDIMENT CONTROL REQUIREMENTS

THE EROSION AND SILTATION CONTROL PROGRAM HAS BEEN PROPOSED IN TWO (2) STAGES WHERE THE STAGE I CONTROL FACILITIES SHALL BE INSTALLED BEFORE OTHER GRADING AND CONSTRUCTION STARTS AND THE STAGE II CONTROL FACILITIES SHALL BE INSTALLED AFTER THE FINAL GRADING.

CONTROL MEASURES SHALL BE INSTALLED AS SHOWN ON THE STAGE I AND STAGE II PLANS. CONTROLS INSTALLED UNDER THE STAGE I PLAN MAY REQUIRE REVISIONS AS CONSTRUCTION PROGRESSES BUT ARE INTENDED TO REMAIN FOR THE DURATION OF THE PROJECT. ADDITIONAL CONTROLS WILL BE PROVIDED UNDER STAGE II.

EROSION AND SILTATION CONTROL MEASURES FOR STAGE I WILL INCLUDE:

- CONSTRUCTION ENTRANCE.
- SILT FENCE.
- TREE PROTECTION.

EROSION AND SILTATION CONTROL MEASURES FOR STAGE II WILL INCLUDE:

- PROVIDE PERMANENT SEEDING.

VEGETATIVE MEASURES WILL INCLUDE:

- TEMPORARY SEEDING (3.31) - NO AREA SHALL REMAIN DENUDED FOR MORE THAN SEVEN (7) DAYS. TEMPORARY SEEDING MAY BE USED DURING SEASONS WHEN PERMANENT SEED IS PROHIBITED.
- PERMANENT SEEDING (3.32) - ALL AREAS DENUDED BY THIS CONSTRUCTION SHALL BE STABILIZED WITH APPROPRIATE TURF GRASSES, GROUND COVER, AND/OR OTHER ACCEPTABLE MEASURES TO BE DETERMINED BY OWNER.

ANTICIPATED PHASING OF CONSTRUCTION:

- FLAG LIMITS OF GRADING AND ESTABLISH TREE PROTECTION MEASURES.
- INSTALL STAGE I EROSION SEDIMENT CONTROLS.
- RECEIVE O.K. FROM THE COUNTY INSPECTOR TO PROCEED.
- REMOVE AND RELOCATE EXISTING CONCRETE DUMPSTER PAD AND ENCLOSURE.
- REMOVE FENCES, FUNBRELLE ANCHORS, EXISTING WADING POOL, AND ALL OTHER ENTITIES CALLED OUT ON THE DEMOLITION PLAN.
- PREPARE EXISTING CONCRETE DECK FOR MATCHING CONCRETE DECK EXTENSION.
- INSTALL CONCRETE DECK EXTENSIONS, FAMILY PLAY POOL, DUAL WATER SLIDES AND TOWER, AND ALL FENCES CALLED OUT TO BE REPLACE ON THE GRADING PLAN.
- REMOVE STAGE I EROSION/SEDIMENT CONTROLS.
- INSTALL PERMANENT SEEDING (STAGE II EROSION SEDIMENT CONTROL).
- REMOVAL OF ANY REMAINING EROSION AND SILTATION CONTROLS WITH THE APPROVAL OF THE COUNTY INSPECTOR.

EROSION AND SEDIMENT CONTROL NARRATIVE CONT

MAINTENANCE:

- ALL MEASURES ARE TO BE INSPECTED DAILY BY THE SITE SUPERINTENDENT OR HIS REPRESENTATIVE. ANY DAMAGED MEASURES ARE TO BE REPAIRED BY THE END OF THE DAY.
- TRAPPED SEDIMENT IS TO BE REMOVED AS REQUIRED TO MAINTAIN EFFICIENCY AND TO BE DISPOSED OF BY SPREADING ON-SITE.
- CONTROLS MAY BE REMOVED AFTER AREAS ABOVE THEM HAVE BEEN STABILIZED AND WITH APPROVAL OF THE SITE INSPECTOR.



COMMONWEALTH OF VIRGINIA
DEPARTMENT OF PUBLIC HEALTH
COUNTY OF LOUDOUN

1 HARRISON STREET, S.E.
P. O. BOX 7000
LEESBURG, VA 20177-7000

September 19, 2000

Phone 703/777-0234
Metro 703/478-8408



Fax 703/777-0233
TDD 703/777-0382

Mr. Tim Geisler
Northern Virginia Regional Park Authority
5400 Ox Road
Fairfax Station, Virginia 22039-1022

RE: LCTM 64/5

Dear Mr. Geisler:

Your request for a waiver to the Loudoun county policy SOP 3.11A has been approved with the condition that the well be abandoned as specified in the permit and the abandonment witnessed by this office.

Should you have any questions concerning this matter, please feel free to contact me at (703) 777-0234.

Respectfully,

J. D. Franklin

Jerry D. Franklin
Sr. Environmental Health Specialist
Division of Environmental Health

cc: file
JDF/ATA/jdf
a:Geisler.ltr



REVISIONS

SURVEY	DESIGN	DRAWN	CHECKED
	W.H.G.A.	J.T.WILL IAMS	J.T.WILL IAMS
		J.T.WILL IAMS	J.McCLELLAN

ENGINEERS • SURVEYORS • LAND PLANNERS • LANDSCAPE ARCHITECTS
William H. Gordon Associates, Inc.
4501 Daly Drive • Chantilly, Virginia 20151
(703) 263-1900 • METRO (703) 803-9508 • FAX (703) 263-0786

DATE: OCTOBER 6, 2000

SCALE: HORIZ: N/A
VERT: N/A

SEAL

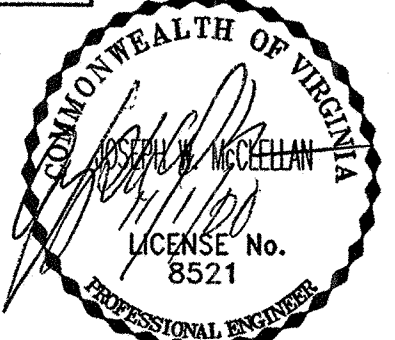

GENERAL NOTES & LETTERS
ALGONKIAN REGIONAL PARK POOL RENOVATION
BROAD RUN DISTRICT
LOUDOUN COUNTY, VIRGINIA

JOB	0520-0501
CADD	0520NT1.DWG
SHEET	2 OF 6

Well/Water System Construction Permit Page 1 of 1

Loudoun County, Virginia Health Department
Division of Environmental Health 777-0234 Metro 478-8408

Health Department Identification Number 1193 FW 00
Map Reference

General Information # 7575

New Repair Abandonment Upgrade Well ID #
Based on the application for a well/water supply system construction permit filed in accordance with Chapter 1040, Code of Ordinances, a construction permit is hereby issued to:
Owner Northern Va. Regional Park Authority Telephone (540) 352-5900
Address 5400 Ox Rd. Fairfax, Va. 22039

For a well/water system which is to be constructed on at Rt. 7 E. to Cascades Pkwy. go N. on Cascades Pkwy. to Park entrance L. at First Rd. to pool.
Subdivision Section/Block Lot



DESIGN	NOTE: INSPECTION RESULTS
Water supply, existing: (describe) <u>III B</u>	Water supply location: Satisfactory yes <input type="checkbox"/> no <input type="checkbox"/>
To be installed: class <u>III B</u>	Drillers Report (G.W.2) Received yes <input type="checkbox"/> no <input type="checkbox"/>
Cased and Grouted to Bedrock plus 10' or a minimum cased <u>100'</u> Grouted <u>100'</u> whichever is greater	Well Construction Approval yes <input type="checkbox"/> no <input type="checkbox"/>
Well Location See Page <u>109</u>	Sanitarian Date
	Well Driller Lic #
	Pump Installer Lic #
I. If well yield as determined by 30 minute air lift test is less than 5 gallons per minute, a pumping test must be performed as follows:	Chemical Quality Data Received yes <input type="checkbox"/> no <input type="checkbox"/> N/A <input type="checkbox"/>
A. Pump and related equipment shall be installed and the static water level measured.	Pumping Data Received yes <input type="checkbox"/> no <input type="checkbox"/> N/A <input type="checkbox"/>
B. Pumping shall begin at a rate of withdrawal greater than 5 GPM until water level drops to a point close to bottom of the well.	As built sketch on page
C. At this point, the pump rate shall be adjusted so the water level remains constant.	Bacteriological Sample Received yes <input type="checkbox"/> no <input type="checkbox"/>
D. Measure and record the volume of water discharge and water level (electric tape) at 15 minute intervals throughout the test.	Water System Approved yes <input type="checkbox"/> no <input type="checkbox"/>
E. Discharge water at least 50 feet from the well and sewage disposal area.	Sanitarian Date
F. Interruption of pumping longer than 15 minutes shall require extending the pumping time that amount of time.	II. Criteria for approval of well and well yield are as follows: The well must produce a: A. Minimum of 1 gallon per minute for 6 continuous pumping hours after the well has been pumped out according to Part I, Sec. B of this permit. B. The pump test can be terminated early and well yield considered adequate if: 1. The well cannot be pumped out as stated in Part I B of this permit. 2. The Well yields 2.5 gpm or greater for 3 hours of continuous pumping after Part I B of this permit is completed. C. Sufficient storage and yield may be considered for approval. D. Person conducting the pump test shall collect a sample to be analyzed for constituents described in Code of Ordinances of Loudoun County Title 4, Chapter 1040, Appendix III. E. Replacement wells are exempt from this requirement.

The well/water system is to be constructed as specified by the permit or attached plans and specifications .
This water system construction permit is null and void if (a) conditions are changed from those shown on the application (b) conditions are changed from those shown on the construction permit.

Date: 8/15/00 Issued by: *J. D. Franklin*
Date: 8/16/00 Reviewed by: *J. D. Franklin*
This Construction Permit Valid until 8/15/01

Original / Health Department Copy / Applicants Copy

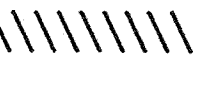
LEGEND

-  EXISTING BUILDING, FOUNDATIONS AND FOOTINGS TO BE DEMOLISHED
-  UNDERGROUND UTILITIES TO BE REMOVED OR ABANDONED
-  TREES TO BE REMOVED OR RELOCATED
- XXXXXXXXXX ABOVE GROUND ENTITIES, FENCES, ETC. TO BE REMOVED OR REPLACED

DEMOLITION NOTES

1. THE EXISTING WADING POOL ALONG WITH FENCES, WELL, ABOVE AND UNDER GROUND UTILITIES, ARE TO BE DEMOLISHED AND CLEARED FROM PROPOSED CONSTRUCTION AREA.
2. THE EXISTING WELL HAS BEEN PREVIOUSLY PERMITTED TO BE CUT AND CAPPED PER VIRGINIA DEPARTMENT OF HEALTH REQUIREMENTS. SEE SHEET #2 FOR THE EXISTING PERMIT.

SURVEY	W.H.G.A.
DESIGN	J.T.WILLIAMS
DRAWN	J.T.WILLIAMS
CHECKED	J.McCLELLAN

GA
 ENGINEERS • SURVEYORS • LAND PLANNERS • LANDSCAPE ARCHITECTS
William H. Gordon Associates, Inc.
 4601 Doby Drive • Chantilly, Virginia 20151
 (703) 263-1900 • METRO (703) 800-9508 • FAX (703) 263-0766

DATE	10/6/00
SCALE	HORZ: 1" = 20' VERT: N/A

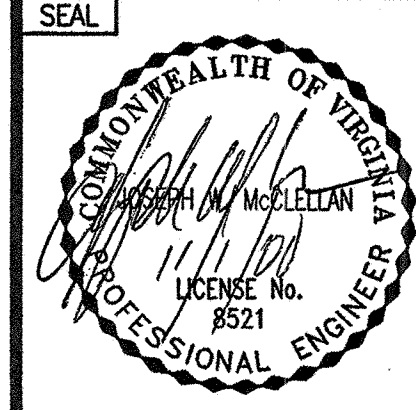

DEMOLITION PLAN

**ALGONKIAN REGIONAL PARK
 POOL RENOVATION**
 BROAD RUN DISTRICT
 LOUDOUN COUNTY VIRGINIA

PROJECT	ALGONKIAN REGIONAL PARK POOL RENOVATION
JOB	0520-0501
CADD	0520demo.DWG
SHEET	3 OF 6

NO.	DESCRIPTION	REVISION	APPROVED	DATE

REVISION APPROVED BY
 DIVISION OF DESIGN REVIEW

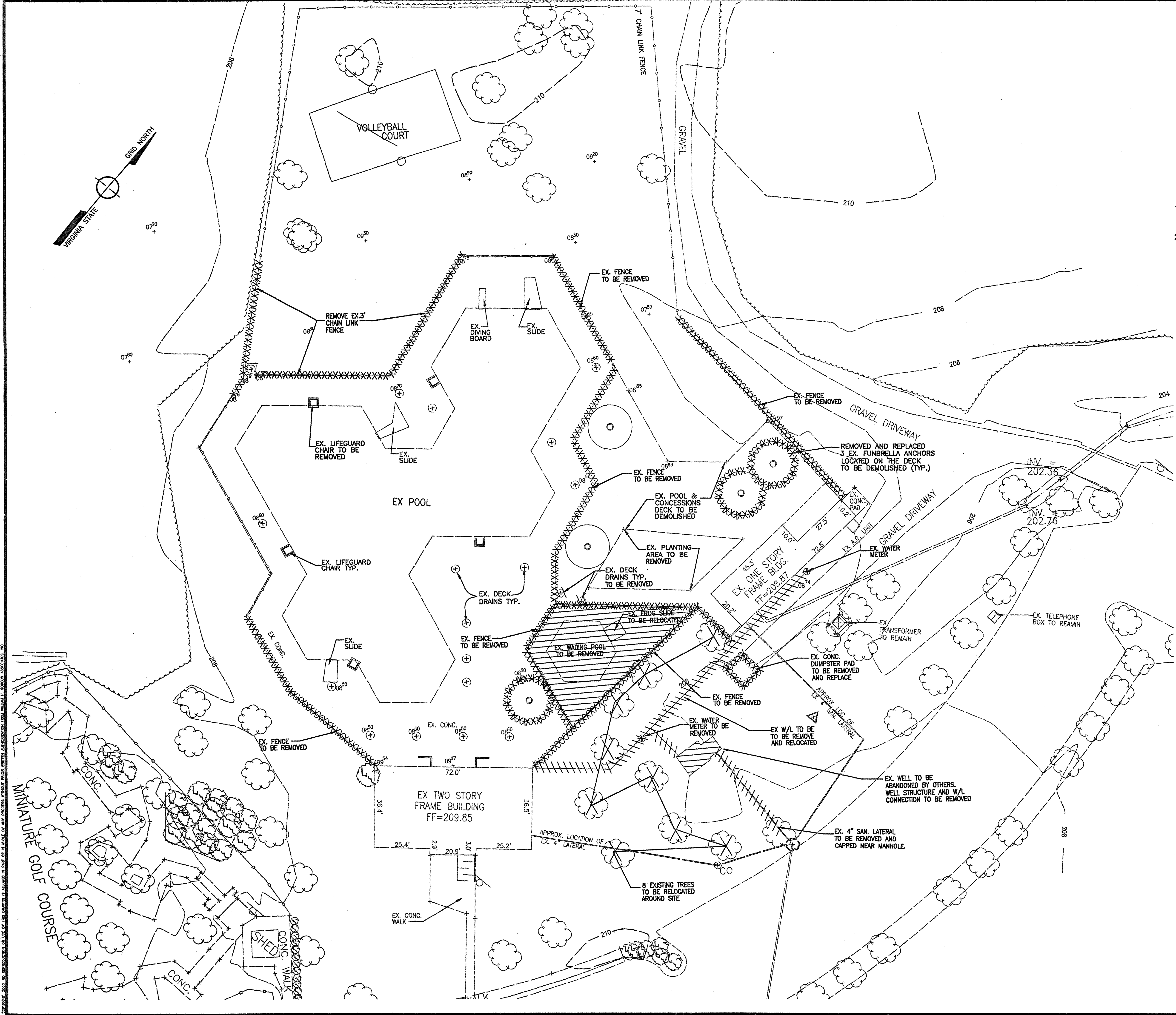

**BMP WATER QUALITY BASINS
EXAMPLE COMPUTATIONS**

BMP VOLUME COMPUTATION FOR WATER QUALITY BASIN #1

DRAINAGE AREA = 0.30 ACRES

VOLUME OF FIRST INCH OF RAINFALL RUNOFF (BMP VOLUME REQUIRED) = $(1.73 \text{ ac})(43,560 \text{ ft}^2/\text{ac})(1.0 \text{ in}) / (12 \text{ in/ft}) = 1,117 \text{ CF}$

BMP WATER SURFACE ELEVATION = 207.0 FT
BMP VOLUME PROVIDED @ BMP WSE = 1,120 CF

BMP 24 HOUR DRAWDOWN COMPUTATION
AVERAGE ORIFICE FLOW IS APPROXIMATELY 60 PERCENT OF PEAK ORIFICE FLOW (ORIFICE SIZING DOES NOT FACTOR OUTFALL RESTRICTIONS DUE TO STONE AND/OR FILTER FABRIC)

WATER SURFACE ELEVATION = 207.0 FT
ORIFICE ELEVATION = 202.8 FT
ORIFICE HEAD = 4.2 FT

AVERAGE FLOW = $\frac{1,120 \text{ CF}}{(24 \text{ hr})(60 \text{ min/hr})(60 \text{ sec/min})} = 0.013 \text{ CFS}$

ALLOWABLE PEAK ORIFICE FLOW = $\frac{0.013}{0.60} = 0.02 \text{ CFS}$

OUTLET ORIFICE DIAMETER = 0.5 IN
OUTLET ORIFICE AREA = 0.0025 SF

PEAK FLOW THROUGH THIS ORIFICE = $(Cd)(0.005 \text{ SF})\sqrt{(0.50)(g)(4.2 \text{ FT})} = 0.0123 \text{ CFS}$

CONSTANTS USED FOR ALL PEAK FLOW COMPS:
Cd=0.6=OVERALL ORIFICE COEFF. OF DISCHARGE
g=32.2 ft/sec²=ACCELERATION OF GRAVITY

ACTUAL DRAWDOWN = $\frac{1,120 \text{ CF}}{(0.60)(0.0123 \text{ CFS})(60 \text{ sec/min})(60 \text{ min/hr})} = 42.0 \text{ HRS}$
(USING AVG. FLOW, (0.60)(0.0123 CFS)(60 sec/min)(60 min/hr)
AVERAGE=PEAK*60%)

BMP WATER QUALITY BASINS COMPUTATION TABLE

BMP WATER QUALITY BASIN #	SHOWN ON GRADING PLAN SHEET #	4" PIPE INV. OUT OF ORIFICE (O) FT.	4" PIPE INV. IN (H) FT.	CLEANOUT PIPE LENGTH (L) FT.	OVERFLOW/BMP WATER SURFACE ELEV. (B) FT.	OUTLET ORIFICE DIAMETER (D) IN.	DRAINAGE AREA AC.	BMP VOLUME REQUIRED CF	BMP VOLUME PROVIDED CF	ORIFICE HEAD FT.	AVERAGE FLOW CFS	ALLOWABLE PEAK ORIFICE FLOW CFS	OUTLET ORIFICE AREA SF	PEAK FLOW THIS ORIFICE CFS	ACTUAL DRAWDOWN HRS. (30 HR. MIN.)
1	4	202.80	203.18	75	207	0.50	0.30	1,117	1,120	4.2	0.013	0.02	0.0025	0.0123	42

BMP NARRATIVE

BEST MANAGEMENT PRACTICES (BMP) HAVE BEEN PROVIDED FOR ONLY THE INCREASE IN IMPERVIOUS AREA FOR THIS SITE SINCE THIS SITE WAS DEVELOPED PRIOR TO FACILITIES STANDARDS MANUAL REQUIRING BMP. THE INCREASE IN IMPERVIOUS AREA IS APPROXIMATELY 13,403 SQUARE FEET (SEE MAP THIS SHEET). WITH THE ADDITION OF A WATER QUALITY BASIN, THIS SITE PROVIDES THE REQUIRED BMP STORAGE AND DRAWDOWN FOR THE INCREASE IN IMPERVIOUS AREA.

OUTFALL NARRATIVE

THIS SITE LIES WITHIN THE 100 YEAR FLOODPLAIN FOR THE POTOMAC RIVER AND, THEREFORE IN THE OPINION OF THIS ENGINEER HAS AN ADEQUATE OUTFALL PER THE STANDARDS SET FORTH IN THE LOUDOUN COUNTY FACILITIES STANDARDS MANUAL.

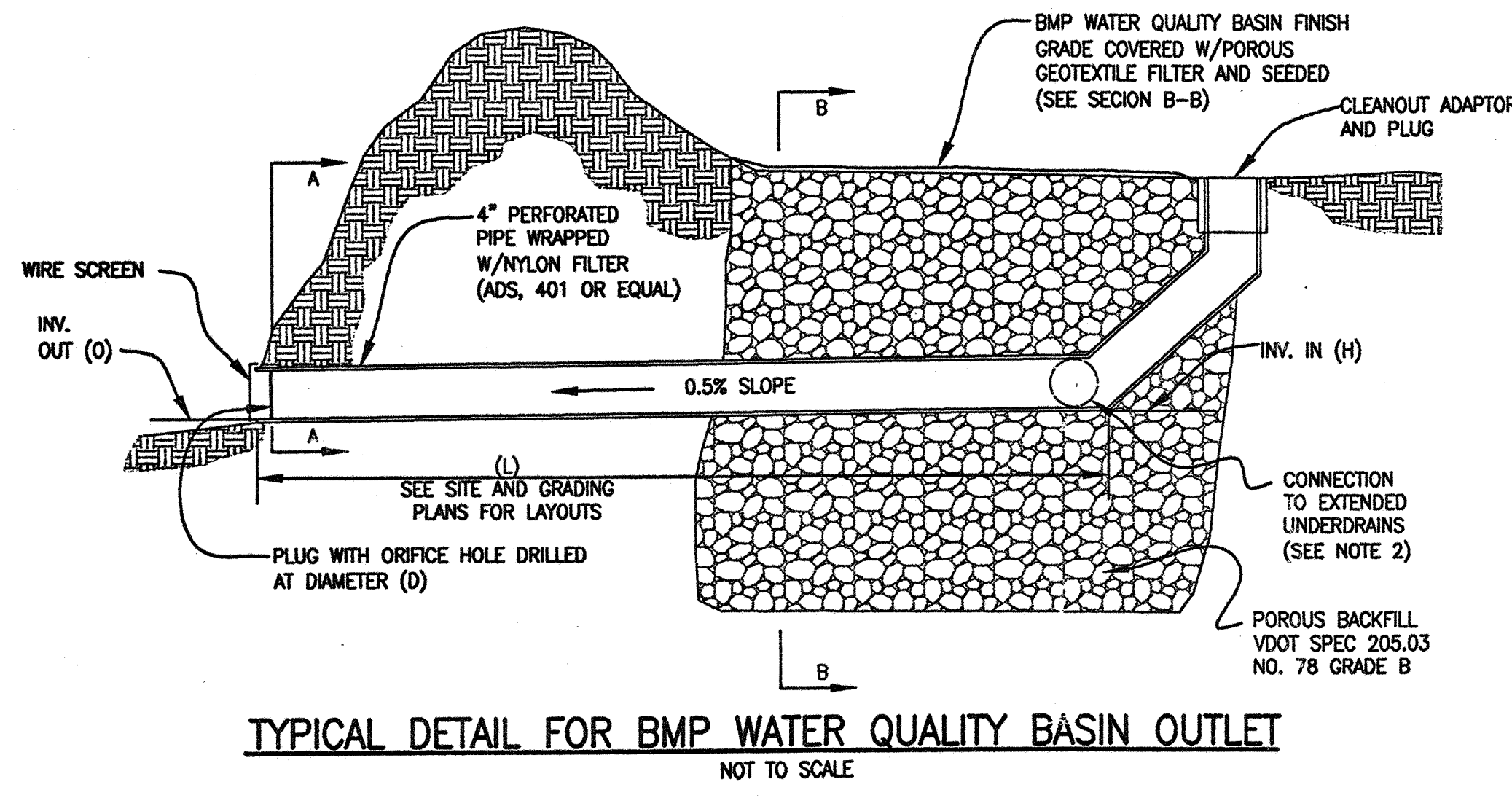
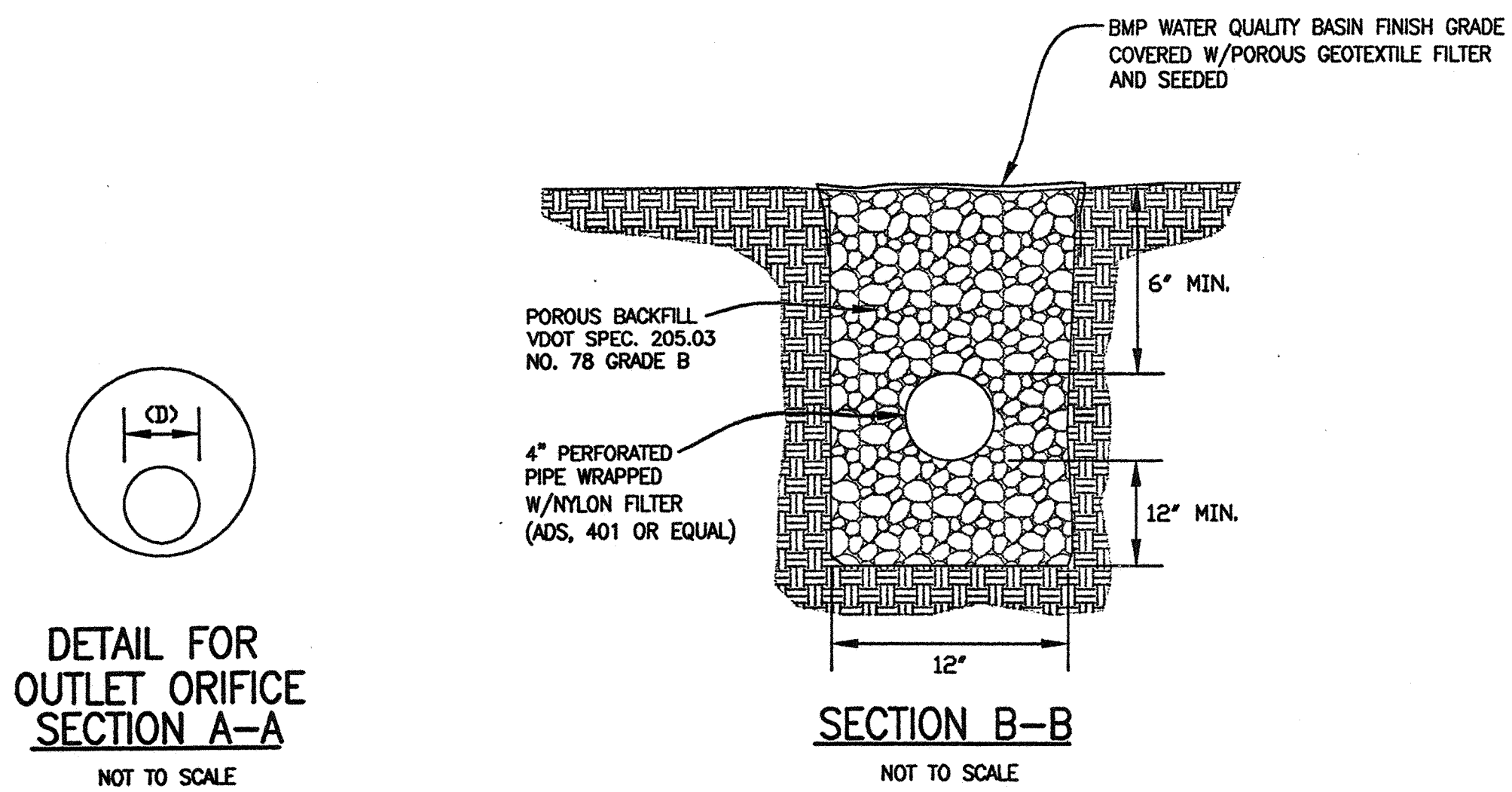

- NOTES:**
- CLEANOUT LENGTH (L) TO BE FROM INVERT OUT TO FIRST PIPE JUNCTION.
 - EXTENDED UNDERDRAINS TO BE FIELD LOCATED WITH SLOPE 0.5%.

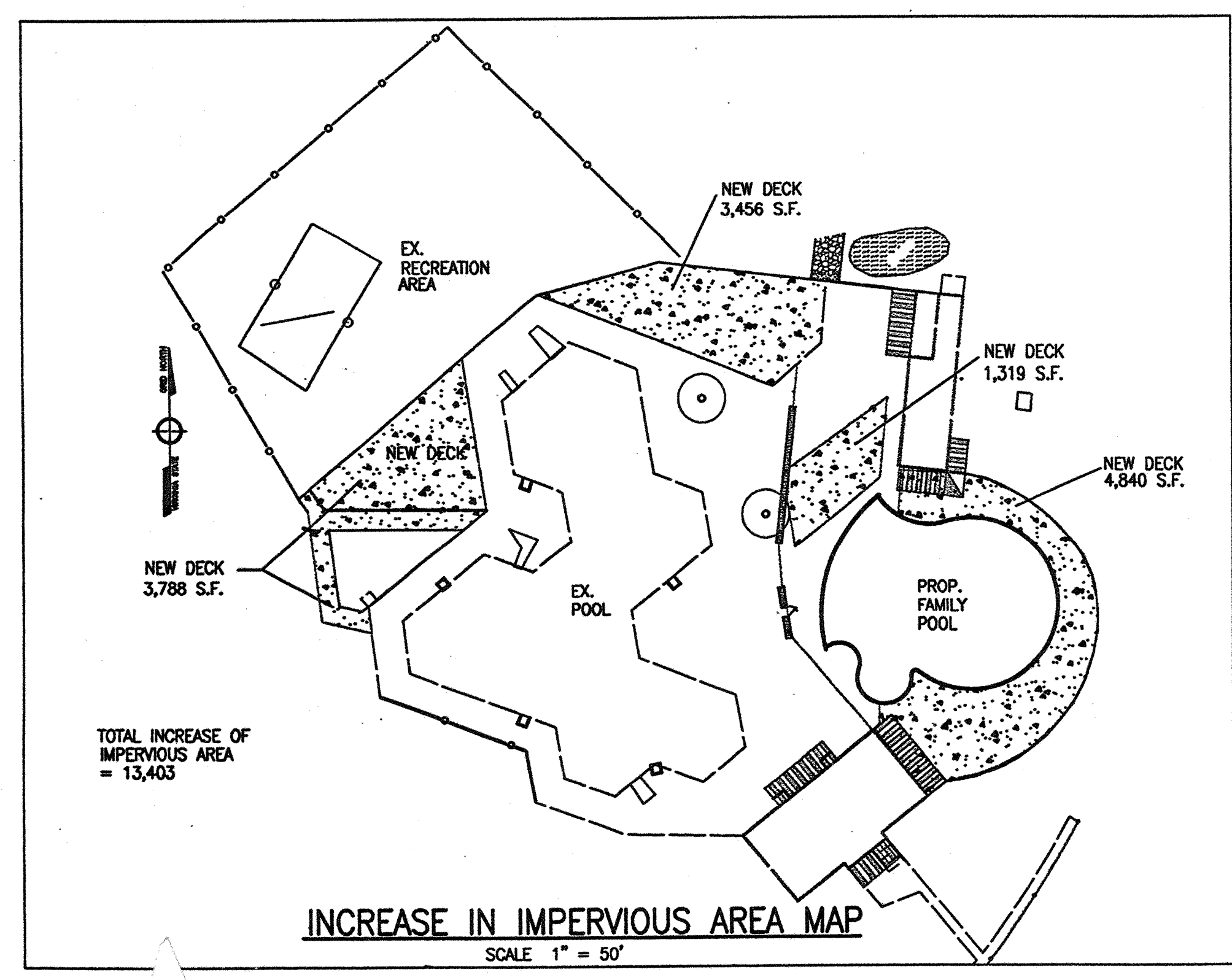

NO.	DESCRIPTION	REVIEW BY	APPROVED	DATE

REVISION APPROVED BY
DIVISION OF DESIGN REVIEW

DATE: OCTOBER, 2000

SCALE: HORZ: N/A
VERT: N/A

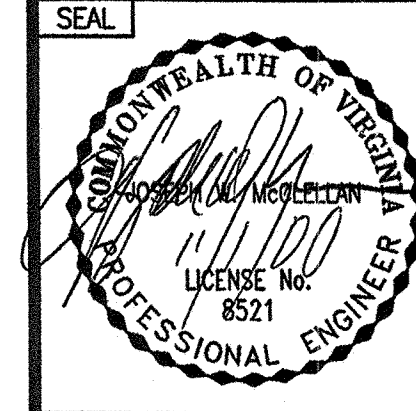

PROJECT: WATER QUALITY (BMP) FACILITY AND NARRATIVES

**ALGONKIAN REGIONAL PARK
POOL RENOVATION**
BROAD RUN, DISTRICT
LOUDOUN COUNTY, VIRGINIA

JOB: 0520-0501
CADD: 0520BMP.DWG
SHEET: 6 OF 6

William H. Gordon Associates, Inc.
ENGINEERS • SURVEYORS • LAND PLANNERS • LANDSCAPE ARCHITECTS
4501 Duly Drive • Chantilly, Virginia 20151
(703) 263-1900 • METRO (703) 803-9908 • FAX (703) 263-0766